

### Assembly tips:

- Part numbers are printed on the back side of the metal sheet.
- Insert tab through hole then bend ● or twist ▲ 90degrees.
- If needed, slightly twist tabs to easily hold parts together then untwist and bend them as noted in the instruction sheet.
- Wire cutters and tweezers are recommended for model assembly.
- Refer to the finished model at [www.metalearth.com/360/mms333](http://www.metalearth.com/360/mms333).

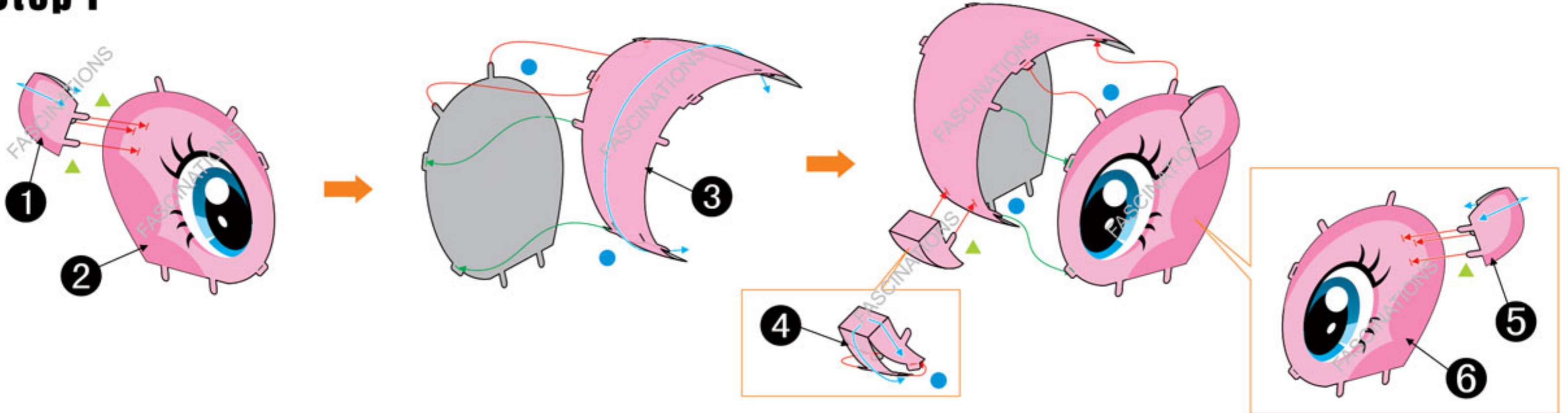

## Step 1



## Step 2

